

# TIMEX®

*Model Ti72*

## NATURE SOUNDS STEREO CLOCK RADIO FOR YOUR iPod





**CAUTION**  
**RISK OF ELECTRIC SHOCK.**  
**DO NOT OPEN**



**CAUTION: TO REDUCE THE RISK OF ELECTRIC SHOCK, DO NOT REMOVE COVER (OR BACK). NO USER-SERVICEABLE PARTS INSIDE. REFER SERVICING TO QUALIFIED SERVICE PERSONNEL.**

**WARNING: TO REDUCE THE RISK OF FIRE OR ELECTRIC SHOCK, DO NOT EXPOSE THIS APPLIANCE TO RAIN OR MOISTURE.**



The lightning flash with arrowhead symbol, within an equilateral triangle, is intended to alert the user of the presence of uninsulated "dangerous voltage" within the product's enclosure that may be of sufficient magnitude to constitute a risk electric shock to persons.



The exclamation point within an equilateral triangle is intended to alert the user of the presence of important operating and maintenance (servicing) instructions in the literature accompanying the appliance.

The symbols above are located at the bottom of the cabinet.

**CAUTION:** To prevent electric shock, do not use this (Polarized) plug with an extension cord receptacle, or other outlets unless the blades can be fully inserted to prevent blade exposure.

**ATTENTION:** Pour prévenir les chocs électriques ne pas utiliser cette fiche polarisée avec un prolongateur. Une prise de courant, ou une autre sortie de courant sauf si les lames peuvent être insérées à fond sans en laisser aucune partie à découvert.

## A Consumer Guide to Product Safety

- The apparatus shall not be exposed to dripping or splashing and that no objects filled with liquids, such as vases, shall be placed on apparatus.  
L'appareil ne doit pas être exposé aux écoulements ou aux éclaboussures et aucun objet ne contenant de liquide, tel qu'un vase, ne doit être placé sur l'objet.
- Main plug is used as disconnect device and it should remain readily operable during intended use. In order to disconnect the apparatus from the mains completely, the mains plug should be disconnected from the mains socket outlet completely.  
La prise du secteur ne doit pas être obstruée ou doit être facilement accessible pendant son utilisation. Pour être complètement déconnecté de l'alimentation d'entrée, la prise doit être débranchée du secteur.
- Battery shall not be exposed to excessive heat such as sunshine, fire or the like.  
Les piles ne doivent pas être exposées à de forte chaleur, tel qu'à la lumière du soleil, au feu ou autres choses de semblable.
- Caution marking is located at the bottom of apparatus.  
Les précautions d'emploi sont inscrites en bas de l'appareil.
- The marking information is located at the bottom of apparatus.  
Les marquages sont inscrits en bas de l'appareil.

## IMPORTANT SAFETY INSTRUCTIONS

This unit has been designed and manufactured to assure your personal safety. Improper use can result in potential electrical shock or fire hazards.

1. Read these Instructions.
2. Keep these Instructions.
3. Heed all Warnings.
4. Follow all instructions.
5. **Water and Moisture** - Do not use this apparatus near water. For example: near a bathtub, washbowl, kitchen sink, laundry tub, swimming pool or in a wet basement.
6. **Ventilation** - Do not block any of the ventilation openings. Install in accordance with the manufacturers instructions. For example, it should not be situated on a bed, sofa, rug or similar surface that may block ventilation openings. Also, it should not be placed in a built-in installation, such as a bookcase or cabinet that may impede the flow of air through the ventilation openings.
7. **Heat** - Do not install near any heat sources such as radiators, heat registers, stoves, or other apparatus (including amplifiers) that produce heat.
8. **Power Sources** - The unit should be connected to a power supply only of the type described in the operating instructions or as marked on the appliance.
9. **Grounding or Polarization** - Do not defeat the safety purpose of the polarized or grounding - type plug. A polarized plug has two blades with one wider than the other. A grounding type plug has two blades and a third grounding prong. The wide blade or the third prong are provided for your safety. When the provided plug does not fit into your outlet, consult an electrician for replacement of the obsolete outlet.
10. **Power-Cord Protection** - Protect the power cord from being walked on or pinched particularly at plugs, convenience receptacles, and the point where they exit from the apparatus. It is always best to have a clear area from where the cord exits the unit to where it is plugged into an AC outlet.
11. **Cleaning** - Unplug this product from the wall outlet before cleaning. Do not use liquid cleaners or aerosol cleaners. Clean only with a dry cloth.
12. **Non-Use Periods** - The power cord of the unit should be unplugged from the outlet when it is to be left unused for a long period of time.
13. **Objects and Liquid Entry** - Care should be taken so that objects do not fall and liquids are not spilled into the enclosure through openings.
14. **Attachments** - Only use attachments/accessories specified by the manufacturer.
15. **Lightning** - Unplug this apparatus during lightning storms or when unused for long periods of time.
16. **Overloading** - Do not overload wall outlets, extension cords, or integral convenience receptacles as this can result in a risk of fire or electric shock.
17. **Damage Require Service** - Refer all servicing to qualified service personnel. Servicing is required when the apparatus has been damaged in any way, such as power-supply cord or plug is damaged, liquid has been spilled or objects have fallen into the apparatus, the apparatus has been exposed to rain or moisture, does not operate normally, or has been dropped.
18. **Servicing** - The user should not attempt to service the unit beyond that described in the user's operating instructions. All other servicing should be referred to qualified service personnel.
19. **Safety Check** - Upon completion of any service or repairs to this product, ask the service technician to perform safety checks to determine that the product is in proper operating condition.
20. **Antenna** - Do not connect to an external antenna.

Questions? Service? Warranty? Visit [www.timexaudio.com](http://www.timexaudio.com)

## Table of Contents

<b>Quick Start .....</b>	<b>1</b>
<b>Controls and Indicators .....</b>	<b>2</b>
<b>Ti72 display / Installing Clock Backup Batteries / Installing iPod Insert .....</b>	<b>3</b>
<b>Using the Ti72.....</b>	<b>4-6</b>
<b>Using the Optional Remote Control .....</b>	<b>7</b>
<b>Trouble Shooting .....</b>	<b>8</b>
<b>Warranty Information .....</b>	<b>9</b>

## FCC Information

This device complies with Part 15 of the FCC Rules. Operation is subject to the following two conditions: (1) This device may not cause harmful interference, and (2) this device must accept any interference received, including interference that may cause undesired operation.

Warning: Changes or modifications to this unit not expressly approved by the party responsible for compliance could void the user's authority to operate the equipment.

NOTE: This equipment has been tested and found to comply with the limits for a Class B digital device, pursuant to Part 15 of the FCC Rules. These limits are designed to provide reasonable protection against harmful interference in a residential installation. This equipment generates, uses and can radiate radio frequency energy and, if not installed and used in accordance with the instructions, may cause harmful interference to radio communications. However, there is no guarantee that interference will not occur in a particular installation. If this equipment does cause harmful interference to radio or television reception, which can be determined by turning the equipment off and on, the user is encouraged to try to correct the interference by one or more of the following measures:

- Reorient or relocate the receiving antenna.
- Increase the separation between the equipment and receiver.
- Connect the equipment into an outlet on a circuit different from that to which the receiver is connected.
- Consult the dealer or an experienced radio/TV technician for help.

### Maintenance

- Place the unit on a level surface away from sources of direct sunlight or excessive heat.
- Protect your furniture when placing your unit on a natural wood and lacquered finish. A cloth or other protective material should be placed between it and the furniture.
- Clean your unit with a soft cloth moistened only with mild soap and water. Stronger cleaning agents, such as Benzene, thinner or similar materials can damage the surface of the unit.

# Quick start

## 1:power

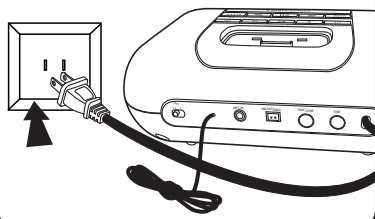

Plug the AC cord into a working wall socket.

## 2:antenna

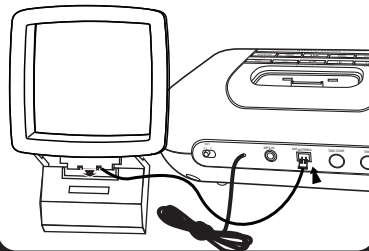

Snap AM antenna into stand, then plug antenna cable into socket on back of Ti72. Move antenna 12" away.

## 3:inserts

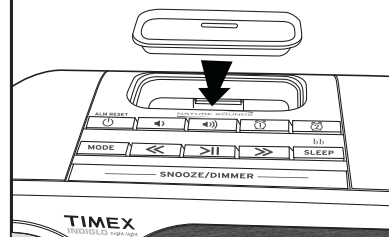

Select the dock insert for your iPod model from the table below and place insert in dock. Never dock an iPod without an insert in place.

**NOTE:** If you do not have an insert for your iPod, please call timex toll free at 800-888-4491 to purchase one.

Use this insert

thin iPod with video (30 GB)  
Insert 9

iPod touch 2G  
Insert 16

nano 4G  
Insert 17

For this iPod

thin (30 GB) iPod with video  
thin (80 GB) iPod classic

iPod touch 2G

nano 4G

## 3:time



- Press & hold the Time Zone button on back until the display flashes
- Press the << or >> button to select your time zone
- Press the Time Zone button again.
- Move the DST switch on back of unit to +1 or -1 (adds or subtracts an hour)

## 4:iPod

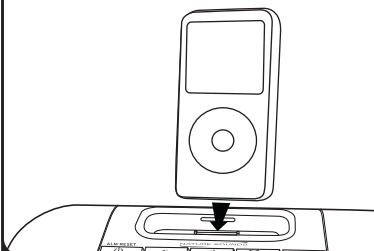

Insert an iPod into the dock with proper insert (iPod must not be in a skin or case). The iPod will charge while docked. Press the >|| Button on the Ti72 to play your iPod.

## 5:radio

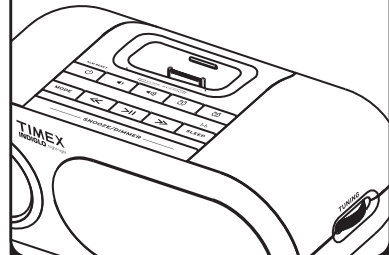

Press the Mode button until AM or FM frequency appears in the lower part of the display. Turn the Tuning dial to tune in a station.

## Controls and Indicators

### Top Panel

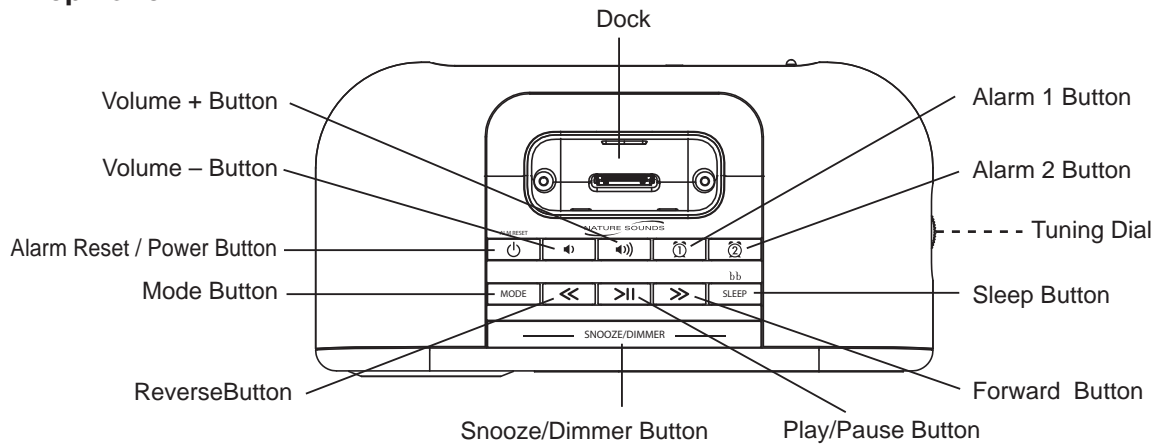

### Rear Panel

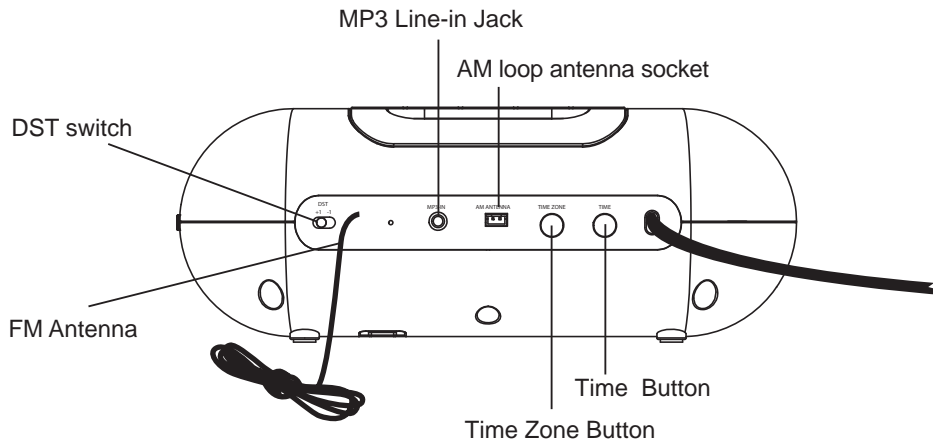

## Ti72 display

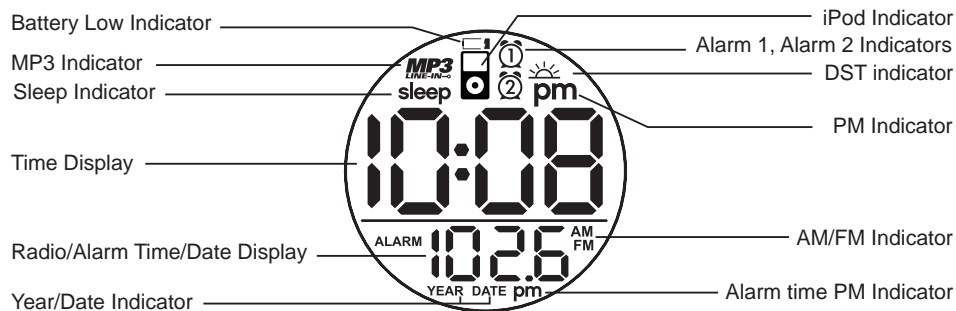

## Installing Clock Backup Batteries

The Ti72 uses 2 AA batteries (installed) for backup to provide continuous alarm operation and clock settings in the event of a power failure. If the backup batteries have been installed and a power failure occurs or if the AC cord is accidentally disconnected, the display backlight will not remain lit, but current time and alarm time settings will be temporarily maintained. Otherwise, you must reset the time and alarm settings.

**Note:** You should replace backup batteries when the **Battery Low Indicator** appears on the display.

1. Please make sure the AC cord is connected. Otherwise all settings may be lost during battery replacement.
2. Open backup battery compartment door located on the bottom of the unit.
3. Insert two "AA" batteries, checking the + and - ends of the batteries. We recommend to use alkaline battery for longer life time. Do not mix alkaline, standard (carbon-zinc) or rechargeable (nickel-cadmium) batteries.
4. Close the compartment cover.

**Note:** Make sure you dispose of batteries properly (see your local regulations).

### Battery Low Indicator

The **Battery Low Indicator** is located in the top of display. When it lights up it is time to replace backup batteries.

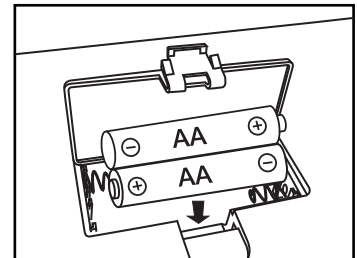

## Installing iPod Insert

Your Ti72 comes with 3 inserts to ensure your iPod fits properly in the dock on the top of the system. If the inserts that come with the unit do not match your iPod model, use the insert that came with your iPod or visit [www.timexaudio.com](http://www.timexaudio.com) or call 1-800-888-4491 toll free to purchase the proper insert for your iPod model.

To place an insert:

1. Select the insert for your iPod. Using the correct insert ensures the proper fit to your iPod.
2. Gently press the iPod insert into the dock.
3. Carefully place your iPod into the dock. The iPod must not be in a case or "skin".
4. To remove/replace an insert, first remove your iPod then press down the insert latch, grip the insert and pull gently upwards.

## Using the Ti72

This unit is a **PRESET Clock/Radio**; the clock is already preset at the factory. You just need to set the time zone for your location.

1. Depending on your location and whether or not Daylight Saving Time (DST) is in effect, set the **DST Switch** located on the back of the unit to +1 to add an hour or to -1 subtract an hour.
2. Press and hold the **Time Zone Button** located on the back of the unit the Time Zone Indicator at the lower part of the display flashes the current time zone. Press the **<< or >> Button** to select your time zone.
3. Press **Time Zone Button** again (or no button within 10 seconds) to exit the setting mode.
4. If the time showing is not correct, please see Setting Time and Calendar to set the clock.

### Setting Time and Calendar

1. Press and hold the **Time Button** located on the back of the unit until the time blinks on the display. Press the **<< or >> Button** to adjust to correct time (holding the button for few seconds to advance or reverse rapidly).
2. Remember to set the correct AM or PM time. **A PM Indicator appears to the right side of the time digits; there is no AM indicator.**
3. Press the **Time Button** again. The year will blink. Press the **<< or >> Button** until the current year is displayed.
4. Press the **Time Button** again to adjust month and date. Press the **<< or >> Button** until the current month/date is displayed. Hold the button for a few seconds to advance or reverse rapidly.
5. Press the **Time Button** again (or no button within 10 seconds) to exit the setting mode.

### Using the Alarms

#### Setting the Alarms

1. Press and hold the **⏰ Button** until the display flashes. Press the **<< or >> Button** to set the alarm time. Remember to set the correct AM or PM time. Press the **Alarm 1 Button** to confirm alarm time.
2. Press the **MODE Button** to select iPod, AM radio, FM radio or Nature sounds to wake to (if AUX is selected, you will wake to buzzer). Set the volume to the level you wish to wake to. Press the **⏰ Button** to exit alarm time setting.
3. Once Nature sounds is selected as the wake to source, the display will show "Sd1" (sound 1). Press the **<< or >> Button** to select the Nature sound you wish to wake to.
4. To set Alarm 2 just repeat step 1 and 3 about but using **⏰ Button**.
5. If you select iPod as the alarm source but no iPod is docked/detected, the Ti72 will default to the buzzer alarm.

**Note:** make sure you have an hour of audio on your iPod.

#### Review, Arming and Disarming Alarm (Turn Alarm Function On and Off)

1. Once alarm is set, it is armed and the lower part of the display will show the alarm time. If both alarms are armed, the earliest alarm time will show.
2. To arm/disarm an alarm, just press the related alarm button to toggle it on or off. If the alarm is armed, the related alarm icon will light up.

#### Resetting the Alarm to Come on the Next Day

1. When the alarm is sounding, press the **⏰ Button** to stop the alarm and reset it to come on the following day at the same time.

## Using the Ti72

### Snooze Operation

1. Press and hold the **Snooze/Dimmer Button** for a few seconds to set snooze time. Press the **<< or >> Button** to set the snooze timer from 1 to 29 minutes.
2. Press the **Snooze/Dimmer Button** when the alarm sounds. The alarm will be silenced and come on again after the set snooze time. Snooze can be pressed several times during the 1 hour alarm cycle.

### Sure Alarm

The Ti72 has a sure alarm feature. If backup batteries are installed, the buzzer alarm will still sound in the event of power failure.

### Charging your iPod

**Note:** Please make sure you are using the correct insert for your iPod (see Installing iPod Insert) and that the iPod is properly docked into the Ti72. Failure to do so may damage your iPod.

1. While your iPod is docked in the unit and the unit is connected to AC power, it recharges (until fully charged). Note that other non-docking iPods will NOT charge.

### Listening to iPod

1. Dock the already playing iPod. The Ti72 will automatically turn on and you will hear the music playing from your iPod.  
**Note:** If the volume on the playing track is too low, the Ti72 may not detect that your iPod is in play mode. If this happens, press the **>|| Button** on the main unit to play it.
2. When the iPod is docked and in standby mode, press the **>|| Button** on main unit to play it. The  icon will appear on the display, showing iPod playing mode.
3. Press the **>|| Button** again to pause play; press again to resume it.
4. Press the **◀ or ▶) Button** to adjust the system volume.
5. Press the **>> or << Button** on main unit to go to the next or previous track. Press and hold while a track is playing for high speed forward or reverse music search of the current track.
6. To turn off the unit, press the **⏻ Button**. The iPod will continue charging while in the dock.

### Listening to non-docking iPod or other portable audio devices

If you are using an iPod without a docking port or another MP3 player or portable audio device, you can play it through the Ti72 via the MP3 Line-in Jack.

1. Plug one end of the audio patch cord (not included) into the headphone or line-out jack on your device and the other end of the patch cord into the Ti72 MP3 Line-in Jack, located on the back of the unit.
2. Press the **⏻ Button** to turn the Ti72 on.
3. Press the **MODE Button** until the  icon appears.
4. Turn on and play your device.
5. Press the **◀ or ▶) Button** to adjust the system volume. You may need to adjust your device volume, too.
6. To turn off the unit, press the **⏻ Button**. Please remember to turn off your device, too.

## Using the Ti72

### Listening to Radio

#### Setting up Antenna

1. Snap the AM antenna cable into AM Antenna Socket on the back of the unit. Move the antenna 12" away from the unit for best reception.
2. Extend FM wire antenna fully for best reception. Do not strip, alter or attach to other antennas.

#### Tuning and Playing the Radio

1. Press the **⏻ Button** to turn on the Ti72.
2. Press the **MODE button** until AM or FM frequency appears in the lower part of the display.
3. Turn the tuning dial to tune the radio to a desired station. The current radio frequency will show in the lower part of the display.
4. Press the **◀ or ▶) Button** to adjust the system volume.
5. To turn off the unit, press the **⏻ Button**.

### Listening to Bedtime Beats or Nature Sounds

1. Press the **⏻ Button** to turn on the Ti72.
2. Press the **MODE button** until the desired Nature sound (Sd1 = wind chimes, Sd2 = birds, Sd3 = ocean surf, Sd4 = brook) or Bedtime Beat (bb1 = classical, bb2 = jazz, bb3 = new age, bb4 = selections from beats 1-3) appears in the lower part of the display.
3. Press the **<< or >> Button** to select the sound. Press the **◀ or ▶) Button** to adjust the system volume.
4. To turn off the unit, press the **⏻ Button**.

### Sleep Operation

Sleep mode lets you sleep to your iPod, radio, or Bedtime beats, gradually lowering the volume until the unit shuts off at a selected time.

1. Press the **SLEEP Button** to enter sleep mode. The Sleep Icon will appear on the display to indicate it is sleep mode.
2. You can adjust the sleep timer from 90, 60, 30 or 15 minutes (or OFF) by pressing the button again.
3. When the display changes back to show the real time, press the **SLEEP Button** once to show the sleep time remaining. Pressing it again will change the sleep time to the next lowest increment.
4. Ti72 has an independent volume setting for sleep mode so you can adjust the sleeping volume without affecting the alarm volume. Press the **◀ or ▶) Button** on the main unit to adjust the sleep volume. The sleep volume will remain at that level the next time you enter sleep mode (until you change it).
5. To stop listening at any time, press the **⏻ Button**.

### Dimmer Operation

During normal operation, press the **Snooze/Dimmer Button** to control the brightness of the LCD display.

## Using the Optional Remote Control

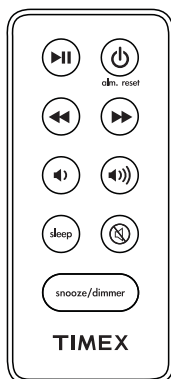

Remote not included with all Ti72 models. To order a remote, please visit [www.timexaudio.com](http://www.timexaudio.com)



Pressing Play/Pause from power off mode will play iPod. Pressing Play/Pause while iPod is docked and playing will pause iPod. Press again to resume play.



Power Button turns unit ON and OFF or resets alarm when alarm is sounding



Pressing FWD/REW while iPod inserted will FWD/REV to next/previous track. Pressing and holding FWD/REV while iPod is docked will scan forward/reverse within currently playing track.



Volume Buttons raise and lower volume on the unit.



Pressing Sleep Button will select an amount of time before the Ti72 shuts off: 90, 60, 30 or 15 minutes (OFF shuts unit off)



Pressing the mute button will mute unit.



Snooze/Dimmer Button snooze mode when alarm sounds, otherwise dims display

### Installing/Replacing the Remote Control Battery

The remote control battery is already installed at the factory. When the remote control stops operating or its range seems reduced, it is time to replace the battery with a new one.

1. The battery door is located on the back end of the remote.
2. Slide the battery door open and remove old battery.
3. Insert a CR2032 battery, checking that the + and - sides of the battery match the drawing inside the battery compartment.
4. Replace the battery door.

**Note:** Make sure you dispose of all batteries properly (see your local regulations).

**CAUTION:** Danger of explosion if battery is incorrectly replaced. Replace only with the same or equivalent type.

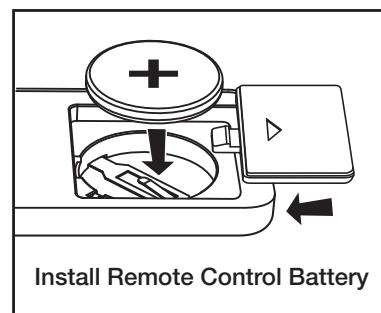

## Trouble Shooting

Symptom	Possible Problem	Solution
Unit doesn't respond (no power)	Wall outlet is not functioning	Plug another device into the same outlet to confirm the outlet is working
iPod does not dock properly	Using no or wrong iPod insert	Make sure the dock insert is the proper one for your iPod
	Dock or connector is obstructed	Remove your iPod from the dock and check for obstruction on the connectors in the dock and on your iPod. Then reseal it in the dock.
iPod does not respond to the unit	iPod is not docked properly	Remove your iPod from the dock and check for obstruction on the connectors in the dock and on your iPod. Then reseal it in the dock.
	Your iPod software is too old	Upgrade software on your iPod via iTunes
	iPod is locked up	Please refer to your iPod manual for details. Please make sure your iPod is working properly before docking in the unit.
iPod doesn't charge up	iPod is not docked properly	Remove your iPod from the dock and check for obstruction on the connectors in the dock and on your iPod. Then reseal it in the dock.
	Using 3rd generation iPod	Ti72 doesn't support 3rd generation iPod
	iPod is locked up/frozen	Please refer to your iPod manual for details. Please make sure your iPod is working properly before dock into the unit.
	iPod battery has problem	
Sound is distorted	Volume level is set too high	Decrease the volume.
	Sound source is distorted	If iPod original sound source is poor quality, distortion and noise are easily noticed with high-power speakers. Try a different audio source such as a music CD.
		If you are using an iPod Shuffle or external sound source like older generation iPod, try reducing the output volume on the device itself. Also, try reducing bass.
Remote Control doesn't work	Remote Battery is weak	Replace with new remote battery
	Remote Control is out of range of the Ti72 remote sensor	Move closer to the unit.

## **Limited 90 day Warranty Information**

Timex Audio Products, a division of SDI Technologies Inc. (hereafter referred to as SDI Technologies), warrants this product to be free from defects in workmanship and materials, under normal use and conditions, for a period of 90 days from the date of original purchase. Should service be required by reason of any defect or malfunction during the warranty period, SDI Technologies will repair or, at its discretion, replace this product without charge (except for a \$10.00 charge for handling, packing, return UPS/postage, and insurance). This decision is subject to verification of the defect or malfunction upon delivery of this product to the Factory Service Center listed below. The product must include proof of purchase, including date of purchase. The fee for service after the warranty period or without proof of purchase is \$30.00.

Before returning this product for service, please first replace the batteries (if applicable) with fresh ones, as exhausted or defective batteries are the most common cause of problems encountered.

If service is still required:

1. Remove batteries (if applicable) and pack the unit in a well-padded, heavy corrugated box.
2. Enclose a photocopy of your sales receipt, credit card statement, or other proof of the date of purchase.
3. Enclose a check or money order payable to the order of SDI Technologies, Inc. for the sum of \$10.00 (or \$30.00 if after the warranty period or without proof of purchase).
4. Send the unit prepaid to the Factory Service Center listed below:

### **Consumer Repair Department**

SDI Technologies Inc.  
Timex Audio Products Division  
1330 Goodyear Drive  
El Paso TX 79936-6420

**NOTE:** This warranty is valid only if the product is used for the purpose for which it was designed. It does not cover (i) products which have been damaged by negligence, misuse or accident, or which have been modified or repaired by unauthorized persons; (ii) cracked or broken cabinets, or units damaged by excessive heat; (iii) damage to tape cassettes (if applicable); (iv) the cost of shipping this product to the Factory Service Center and its return to the owner.

This warranty is valid only in the United States of America and does not extend to owners of the product subsequent to the original purchaser. Any applicable implied warranties are also limited to 90 days, and SDI Technologies will not be liable for consequential damages. (Some states do not allow limitations on implied warranties or exclusion of consequential damages, so these restrictions may not apply to you.) This warranty gives you specific legal rights, and you may also have other rights which vary from state to state.

**© 2008 SDI Technologies, Inc. All rights reserved**

**TIMEX is a registered trademark of Timex Corporation the United States and other countries**