

TW500 - IB (English version)  
 Size: 399 x 266 mm paper sheet, 133 x 133 mm (fold)  
 Color: Black  
 Mat: 85gsm WF paper  
 May, 2, 2022.  
 \* Front

**TIMEX** Model: TW500  
**DUAL ALARM**  
**FM CLOCK RADIO**  
 WITH WIRELESS + USB CHARGING



For additional information, online registration, and exclusive special offers visit our website:  
[www.timexaudio.com](http://www.timexaudio.com)

**Table of Contents**

- What's in the Box ..... 1
- Controls Overview ..... 2
- Display ..... 2
- Backup Battery ..... 3
- Product Care ..... 3
- Set Up ..... 4
- Setting the Time ..... 4
- Setting and Using Alarms ..... 5
- Sleep Mode ..... 6
- Wireless Charging ..... 6-7
- Charging Devices via USB Port ..... 7
- FM Radio and Presets ..... 8
- Troubleshooting ..... 8
- Safety Information ..... 9-10
- Warranty Information ..... 11

- What's in the Box**
- This product ships with the following items. Make sure all are present.
- 1. TW500 Alarm Clock (phone not included)
  - 2. Instruction book
  - 3. Power adapter

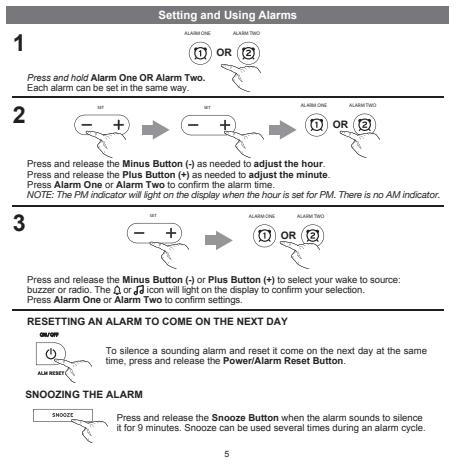
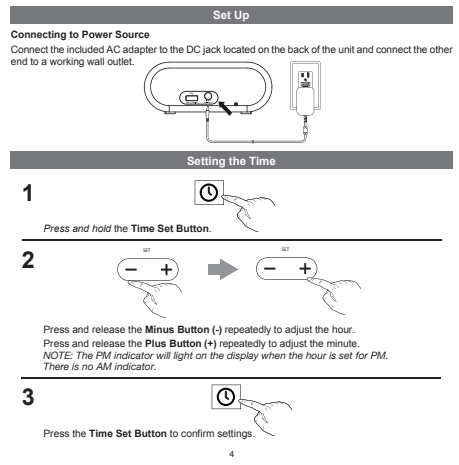
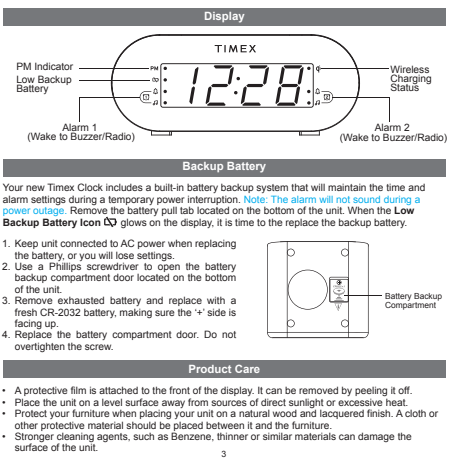
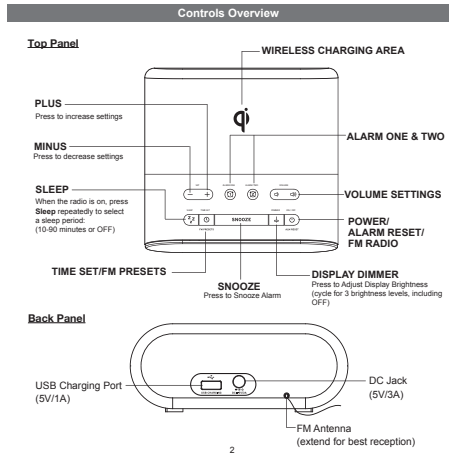

TW500 - IB (English version)  
 Size: 399 x 266 mm paper sheet, 133 x 133 mm (fold)  
 Color: Black  
 Matl: 85gsm WF paper  
 May 25, 2020.  
 • Back

### Sleep Mode

You can set up a sleep timer to automatically shut off the radio at a scheduled time.  
 To do so:  
 1. Press the **Power/Alarm Reset Button** to turn on FM radio.  
 2. Press and release the **Minus Button (-)** or **Plus Button (+)** to select a radio station. (Press and hold to quickly scroll through the stations.)  
 3. Press the **Sleep Mode Button** repeatedly to select a sleep period between 10-90 minutes, or OFF.

### Wireless Charging

Supports:  
 • Qi compatible phones (also works with plastic cases up to 3mm thick)  
 • AirPods with wireless charging case  
 Place Qi compatible device face up on the wireless charging pad as pictured below:

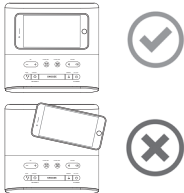

**CAUTION:**  
 Remove metal protective or magnetic case from phone before charging. When charging phone, do not place magnetic-stripped or other metal objects on the charger. Doing so could damage the object or this unit. Qi compatible phones with metallic looking finishes will charge normally.

6

### Wireless Charging (Continued)

Check the Wireless Charging Status LED Indicator to monitor charging status:



**Solid green LED:** Device is charging.  
**Rapid blinking amber LED:** Device is not charging properly. Reposition device.  
**Solid amber LED:** Device fully charged.  
 Note: The LED indicator may continue to glow solid green when iOS devices are fully charged. The LED indicator may alternate between solid green and flashing amber while charging AirPods.

### Charging Devices via USB Port

You can also charge your devices via the USB port located on the back of the unit.

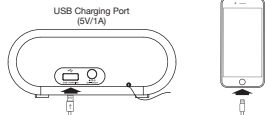

To charge devices:  
 • Connect the standard size end of a USB cable (not included) to the USB port on the back of the unit.  
 • Connect the other end to the charging port on your device.  
 (Make sure the unit is plugged into a working outlet in order to charge devices.)

7

### FM Radio and Presets



• Press the **Power/Alarm Reset Button** to turn on FM radio.  
 • Press and release the **Minus Button (-)** or **Plus Button (+)** to select a radio station. (Press and hold to quickly scroll through the stations.)  
 Make sure the antenna is extended for best reception.

### HOW TO PROGRAM FM RADIO PRESETS

You can store up to 10 FM presets by following these steps:  
 1. Press the **Power/Alarm Reset Button** to turn on FM radio.  
 2. Press and release the **Minus Button (-)** or **Plus Button (+)** to select a radio station. (Press and hold to quickly scroll through the stations.)  
 3. Press and hold the **Time Set/FM Presets Button**. The display will flash.  
 4. Press and release the **Minus Button (-)** or **Plus Button (+)** to choose a preset position between P01-P10.  
 5. Press the **Time Set/FM Presets Button** again to confirm the preset station.  
 6. Repeat steps 2-5 to set up to 10 preset stations.  
 When listening to FM radio, repeatedly press the **Time Set/FM Presets Button** to access your stored stations.

### Troubleshooting

- The unit does not power ON.**  
The unit is not connected to AC outlet, the AC outlet has no power, or is controlled by a wall switch that is "OFF". Check AC outlet and wall switch.
- Alarm does not come on.**  
The alarm time AM or PM incorrectly set, Alarm was OFF, etc. Check alarm settings.
- Unit shuts "OFF" unexpectedly.**
  - A power surge has occurred, or the AC outlet has been disconnected.
  - The AC outlet may be controlled by a wall switch that is turned OFF. Check AC outlet or wall switch.

8

### IMPORTANT SAFETY INSTRUCTIONS

Please heed all warnings, read and follow all instructions and keep these instructions handy for future reference.

- Do not use this product near water, and clean only with dry cloth.
- Do not block any ventilation openings. Install in accordance with the manufacturer's instructions.
- Heat – This product should be situated away from heat sources such as radiators, heat registers, stoves or other appliances (including amplifiers) that produce heat.
- Only use attachments/accessories specified by the manufacturer.
- Unplug this product during lightning storms or when unused for long periods of time.
- Damage Requiring Service – This product should be serviced by qualified service personnel when:
  - Plug has been damaged.
  - Objects have fallen into or liquid has been spilled into the enclosure.
  - The unit has been exposed to rain. The unit has been dropped or the enclosure damaged.
  - The unit exhibits a marked change in performance or does not operate normally.
- No naked flame sources, such as lighted candles, should be placed on this product.
- Attention should be drawn to the environmental aspects of battery disposal.
- This product is suitable for use in tropical and/or moderate climates.
- WARNING:** To reduce the risk of fire or electric shock, do not expose this product to rain or moisture.
- Do not dispose of batteries in the household trash or fire.
- The mains plug of power adaptor is used as the disconnect device, it shall remain readily operable.

**WARNING**  
 Do not ingest the battery, Chemical Burn Hazard. This product contains a coin/button cell battery. If the coin/button cell battery is swallowed, it can cause severe internal burns in just 2 hours and can lead to death.  
 Keep new and used batteries away from children. If the battery compartment does not close securely, stop using the product and keep it away from children. If you think batteries might have been swallowed or placed inside any part of the body, seek immediate medical attention.  
**CAUTION - RISK OF EXPLOSION IF BATTERY IS REPLACED BY AN INCORRECT TYPE. DISPOSE OF USED BATTERIES ACCORDING TO THE INSTRUCTIONS.**

9

### FCC Information

This equipment complies with FCC RF radiation exposure limits set forth for an uncontrolled environment. This device complies with Part 15 of the FCC Rules, operation is subject to the following two conditions:  
 (1) This device may not cause harmful interference, and (2) this device must accept any interference received, including interference that may cause undesired operation.  
 • Warning: Changes or modifications to this unit not expressly approved by the party responsible for compliance could void the user's authority to operate the equipment.  
 • NOTE: This equipment has been tested and found to comply with the limits for a Class B digital device, pursuant to Part 15 of the FCC Rules.  
 These limits are designed to provide reasonable protection against harmful interference in a residential installation. This equipment generates, uses and can radiate radio frequency energy and, if not installed and used in accordance with the instructions, may cause harmful interference to radio communications.  
 However, there is no guarantee that interference will not occur in a particular installation. If this equipment does cause harmful interference to radio or television reception, which can be determined by turning the equipment off and on, the user is encouraged to try to correct the interference by one or more of the following measures:  
 • Reorient or relocate the receiving antenna.  
 • Increase the separation between the equipment and receiver.  
 • Connect the equipment into an outlet on a circuit different from that to which the receiver is connected.  
 • Consult the dealer or an experienced radio/TV technician for help.  
 This equipment should be installed and operated with minimum distance 20cm between the radiator & your body.  
**CAN ICES-3 (B) / NMB-3(B), CAN RSS-216 / CNR-216**

**IC Statement**  
 This equipment complies with IC RSS-102 radiation exposure limits set forth for an uncontrolled environment. This device contains licence-exempt transmitter(s)/receiver(s) that comply with Innovation, Science and Economic Development Canada's licence-exempt RSS(s). Operation is subject to the following two conditions:  
 (1) This device must not cause interference.  
 (2) This device must accept any interference, including interference that may cause undesired operation of the device.  
 The device complies with ISED/RC RF exposure requirement, users can obtain Canadian information on RF exposure and compliance.  
 This equipment should be installed and operated with a minimum distance of 20 cm between the radiator and your body. Any changes or modifications not expressly approved by the party responsible for compliance could void the user's authority to operate the equipment.  
 Cet équipement est conforme aux limites d'exposition aux radiations IC CNR-102 établies pour un environnement non contrôlé. L'émission/réception exempt de licence contenu dans le présent appareil est conforme aux CNR d'Innovation, Sciences et Développement économique Canada applicables aux appareils radio exempts de licence. L'exploitation est autorisée aux deux conditions suivantes:  
 (1) L'appareil ne doit pas produire de brouillage.  
 (2) L'appareil doit accepter tout brouillage radioélectrique subi, même si le brouillage est susceptible d'en compromettre le fonctionnement.  
 L'appareil est conforme aux exigences d'exposition RF ISED, les utilisateurs peuvent obtenir des informations canadiennes sur l'exposition aux RF et la conformité.  
 Cet équipement doit être installé et utilisé avec une distance minimale de 20 cm entre le radiateur et votre corps. Tout changement ou modification non expressément approuvé par la partie responsable de la conformité peut annuler l'autorité de l'utilisateur à utiliser l'équipement.

10

### Limited 90 Day Warranty Information

Timex Audio Products, a division of SDI Technologies Inc. (hereafter referred to as SDI), warrants this product to be free from defects in workmanship and materials, under normal use and conditions, for a period of ninety (90) days from the date of original purchase.  
 Should this product fail to function in a satisfactory manner, it is best to first return it to the store where it was originally purchased. Should this fail to resolve the matter and service still be required by reason of any defect or malfunction during the warranty period, SDI will repair or, at its discretion, replace this product without charge. This decision is subject to verification of the defect or malfunction upon delivery of this product to the Factory Service Center authorized by Customer Service.  
 If service is required, please visit [timexaudio.com/support](http://timexaudio.com/support) for more information. A copy of the sales receipt is required to validate in-warranty coverage.

**Disclaimer of Warranty**  
 NOTE: This warranty is valid only if the product is used for the purpose for which it was designed. It does not cover (i) products which have been damaged by negligence or willful actions, misuse or accident, or which have been modified or repaired by unauthorized persons; (ii) cracked or broken cabinets, or units damaged by excessive heat; (iii) damage to digital media players, CDs or tape cassettes (if applicable); (iv) the cost of shipping this product to the Factory Service Center and its return to the owner.  
 This warranty is valid only in the United States of America and does not extend to owners of the product other than to the original purchaser. In no event will SDI or any of its affiliates, contractors, resellers, their officers, directors, shareholders, members or agents be liable to you or any third party for any consequential or incidental damages, any lost profits, actual, exemplary or punitive damages. (Some states do not allow limitations on implied warranties or exclusion of consequential damages, so these restrictions may not apply to you.) This warranty gives you specific legal rights, and you may also have other rights which vary from state to state.  
 Your acknowledgment and agreement to fully and completely abide by the above mentioned disclaimer of warranty is contractually binding to you upon your transfer of currency (money order, cashier's check, or credit card) for purchase of your SDI product.

© 2020 SDI Technologies, Inc. All rights reserved.  
 Questions? Visit [www.timexaudio.com](http://www.timexaudio.com)

TIMEX is a registered trademark of Timex Corporation in the United States and other countries

TW500B-02/20-C

11

Printed in China